

Epic Precision Replacement Parts For Verdol RM Magnetic Spindle Assembly

EE305544 RM Spindle Assy w/out Twist Plate Assy, 260x175 Reserve

EE304842 Rebuild Customer's RM Spindle Assy, Complete

EE305546 Complete RM Spindle w/Twist Plate Assy, 260-175

EE305544-1 RM Spindle Assy w/out Twist Plate Assy, 260x160 Reserve

EE304842-1 Rebuilt for Exchange, RM Spindle Assy, Complete

EE305546-1 Complete RM Spindle w/Twist Plate Assy, 260x160

EE309057 Labor to Replace Customer's Hub in RM Disc & Balance

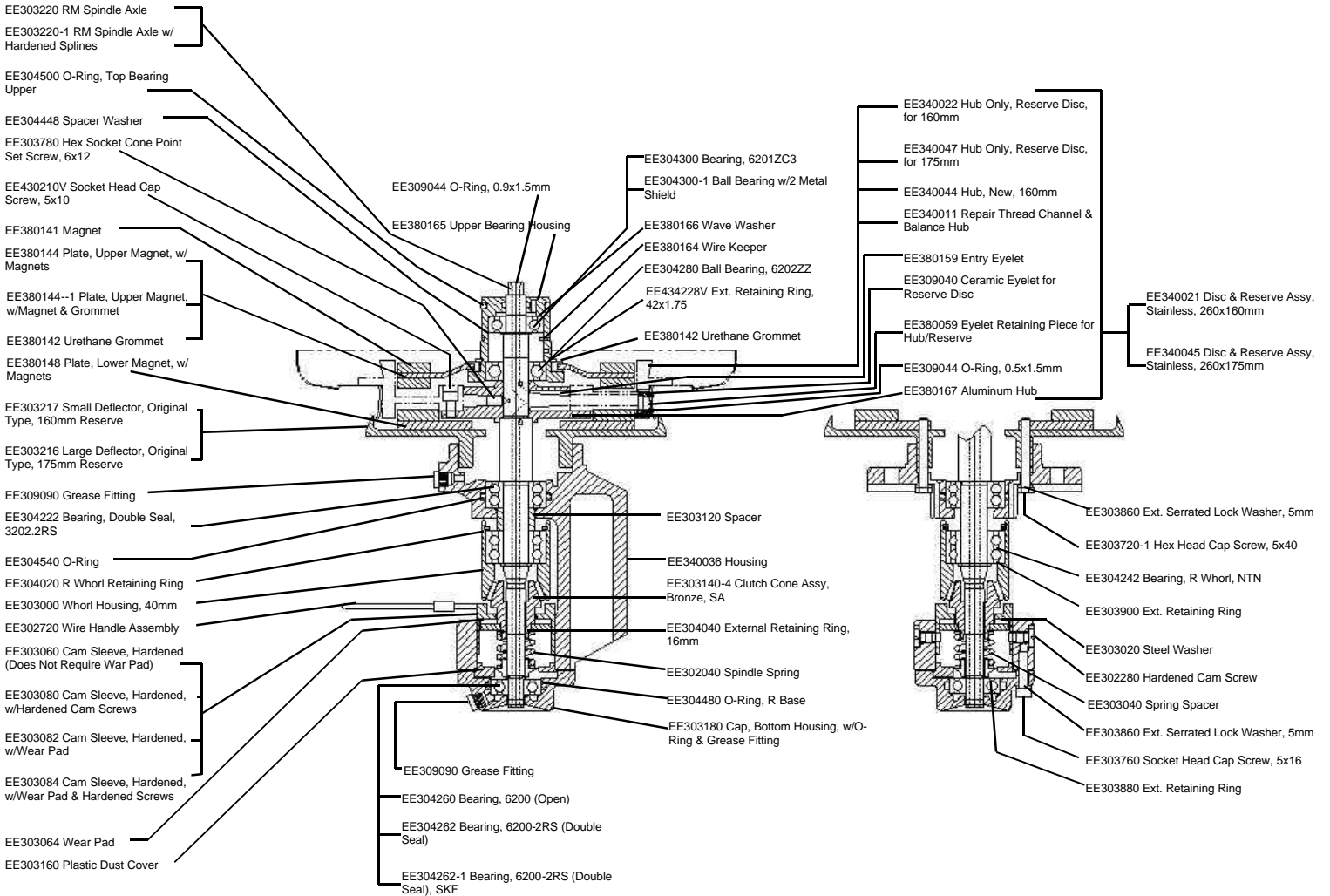

For a complete part listing, call Epic and request assembly drawing VE-18

Epic products are intended as replacements for worn or damaged parts in OEM products. OEM part numbers in parenthesis indicate either 1) improved design, 2) the part serves the same function as the OEM part, but may differ from the OEM design, or 3) it is a component of an assembly where no OEM reference number is available, or 4) it is a repair service for the referenced OEM part.

Verdol is a trademark of ICBT

EE is an Epic trademark designating Epic parts

©Epic Enterprises, Inc., February 2004

Epic Enterprises, Inc., PO Box 979, Southern Pines, NC 28388-0979 USA
Telephone: Toll Free 800-648-7273 or 910-692-5441 Outside USA
Fax: Toll Free 888-692-4147 or 910-692-4147 Outside USA
Website: <http://www.epicenterprises.com> E-Mail: epic@epicenterprises.com

